

Carparking	Total
1 Bed x16	12
2 Beds x 37	37
3 Beds x 9	13.5
Visitors (1 per 7 units)	9
motorcycle parking	2
<b>TOTAL REQUIRED SPACES</b>	<b>71.5</b>
<b>TOTAL PROPOSED SPACES</b>	<b>82 cars+ 2 motorcycles</b>
Disabled	7 (20/3)
<b>Bikes (1 every 5)</b>	<b>12.4</b>
<b>Bikes visitors (1 every 10)</b>	<b>6.2</b>

**NOTE:**  
Car parking is designed in accordance with Australian Standard AS 2890.1 – 2004 – Off Street Car Parking and Australian Standard 2890.2 - 2002 – Off Street Commercial .

All parking areas and driveways are to be sealed to an all weather standard, line marked and signposted.

All vehicular entry on to the site and egress from the site shall be made in a forward direction.

UNITS	Unit storage 50%	Basement storage 50%	Total
204	5.7	6	11.7
205	4.3	12	16.3
206	4.8	9	13.8
207	4.8	6	10.8
208	4.3	6	10.3
209	5.5	6	11.5
210	4.5	6	10.5
211	4.8	6	10.8
212	3	6	9
213	4.5	9	13.5
301	3	6	9
302	4	12	16
303	5	6	11
304	5.7	6	11.7
305	4.3	6	10.3
306	4.8	6	10.8
307	4.8	6	10.8
308	4.3	6	10.3
309	5.5	6	11.5
310	4.5	6	10.5
311	4.8	6	10.8
312	3	6	9
313	4.5	6	10.5
401	4.3	6	10.3
402	5.7	6	11.7
403	4	6	10
404	4.5	6	10.5
405	5.5	12	17.5
406	5	7	12
407	5.2	7	12.2
408	4.7	7	11.7
409	4.7	12	16.7
410	4.3	12	16.3

01 Lower Basement  
1:150 @ A1

E	19/7/16	Parking rates updated
D	24/6/16	Re-submit to council : - Storage schedule added - Double sided bikes - 10 bikes
C	6/10/15	DA Submission
B	24/9/15	Final consultant co-ordination

ISSUE	DATE	REVISION
PROJECT	Multi Residential Development	
ADDRESS	325-327 & 331 Peats Ferry Rd, Asquith	PROJECT # 15002
CLIENT	Max Lucas	DATE # July 2015
DWG	Lower Basement Level	SCALE 1:150 @ A1
		DWG #
		DA 100
		REVISION
		E

**JHArchitects**

Suite 303, 4 Columbia Court  
Baulkham Hills NSW 2153  
M: 0412 287 606



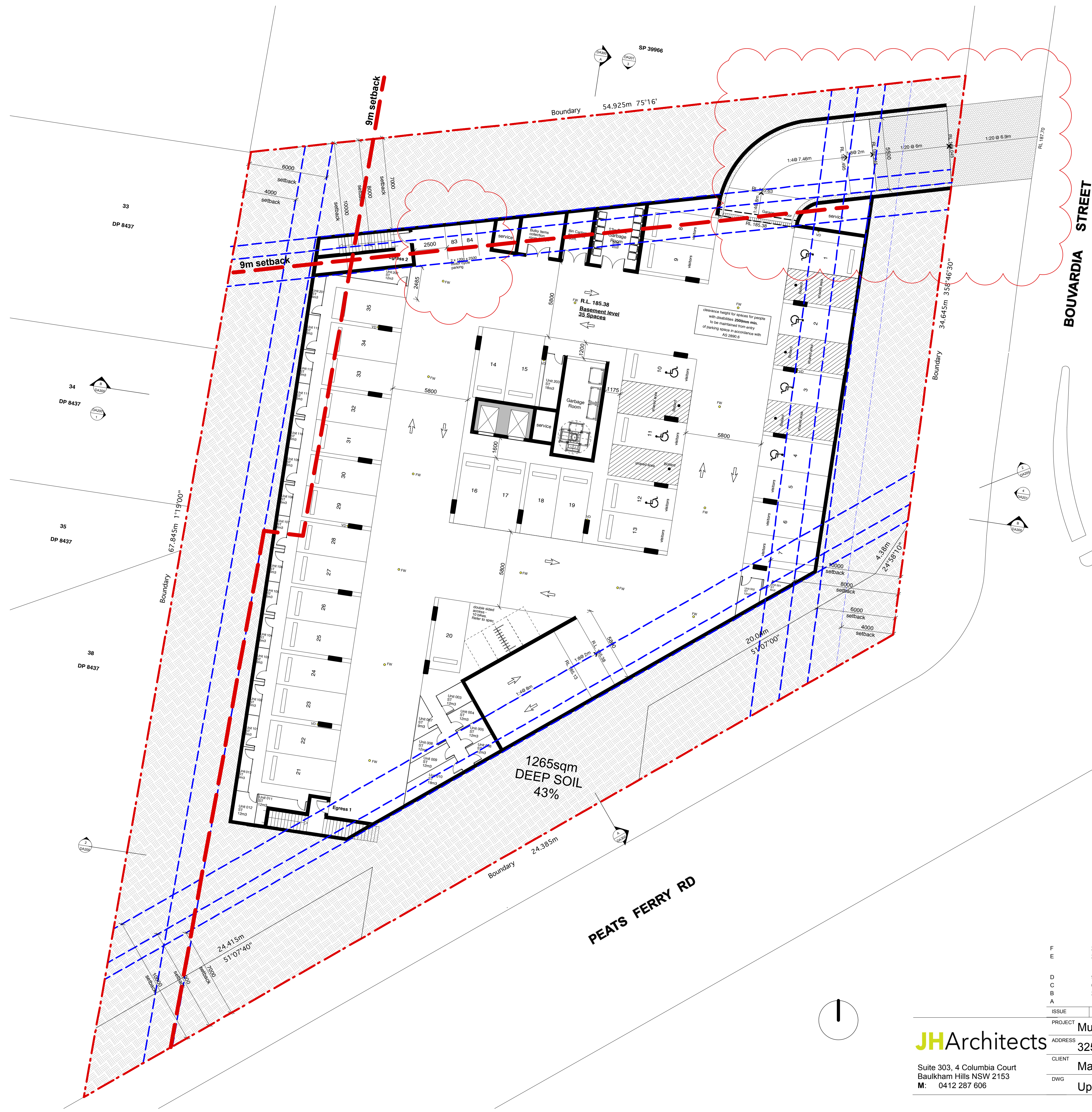

Carparking	Total
1 Bed x16	12
2 Beds x 37	37
3 Beds x 9	13.5
Visitors (1 per 7 units)	9
motorcycle parking	2
<b>TOTAL REQUIRED SPACES</b>	<b>71.5</b>
<b>TOTAL PROPOSED SPACES</b>	<b>82 cars+ 2 motorcycles</b>
Disabled	7 (20/3)
<b>Bikes (1 every 5)</b>	<b>12.4</b>
<b>Bikes visitors (1 every 10)</b>	<b>6.2</b>

**NOTE:**  
Car parking is designed in accordance with Australian Standard AS 2890.1 – 2004 – Off Street Car Parking and Australian Standard 2890.2 - 2002 – Off Street Commercial .

All parking areas and driveways are to be sealed to an all weather standard, line marked and signposted.

All vehicular entry on to the site and egress from the site shall be made in a forward direction.

UNITS	Unit storage 50%	Basement storage 50%	Total
.001	3	6	9
.002	4	12	16
.003	5	12	17
.004	5.7	12	17.7
.005	4.3	12	16.3
.006	4.8	12	16.8
.007	4.8	9	13.8
.008	4.3	12	16.3
.009	5.5	12	17.5
.010	4.5	18	22.5
.011	4.8	12	16.8
.012	3	12	15
.013	4.5	9	13.5
101	3	6	9
102	4	6	10
103	5	6	11
104	5.7	6	11.7
105	4.3	6	10.3
106	4.8	6	10.8
107	4.8	6	10.8
108	4.3	6	10.3
109	5.5	6	11.5
110	4.5	6	10.5
111	4.8	6	10.8
112	3	6	9
113	4.5	6	10.5
201	3	6	9
202	4	12	16
203	5	18	23

01 Upper Basement  
1:150 @ A1

F	25/7/16	Parking rates /driveway updated and 2 motorcycle spaces added
E	24/6/16	Re-submit to council : - Storage schedule added - Double sided bikes - 10 bikes
D	9/2/16	Changes made & re-issue to councils
C	6/10/15	DA Submission
B	24/9/15	Final consultant co-ordination
A	18/2/14	Issue to consultants - Preliminary Issue

ISSUE	DATE	REVISION
PROJECT	Multi Residential Development	
ADDRESS	325-327 & 331 Peats Ferry Rd, Asquith	PROJECT # 15002
CLIENT	Max Lucas	DATE # July 2015
DWG	Upper Basement Level	SCALE 1:150 @ A1
CHKD	JH	DWG # DA 101
REVISION	F	

**JHArchitects**

Suite 303, 4 Columbia Court  
Baulkham Hills NSW 2153  
M: 0412 287 606